

1/8" Micro Die Grinder

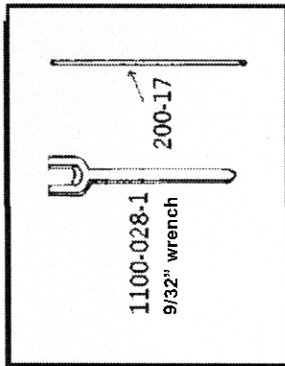

Model 20-GM Case (Muffled)

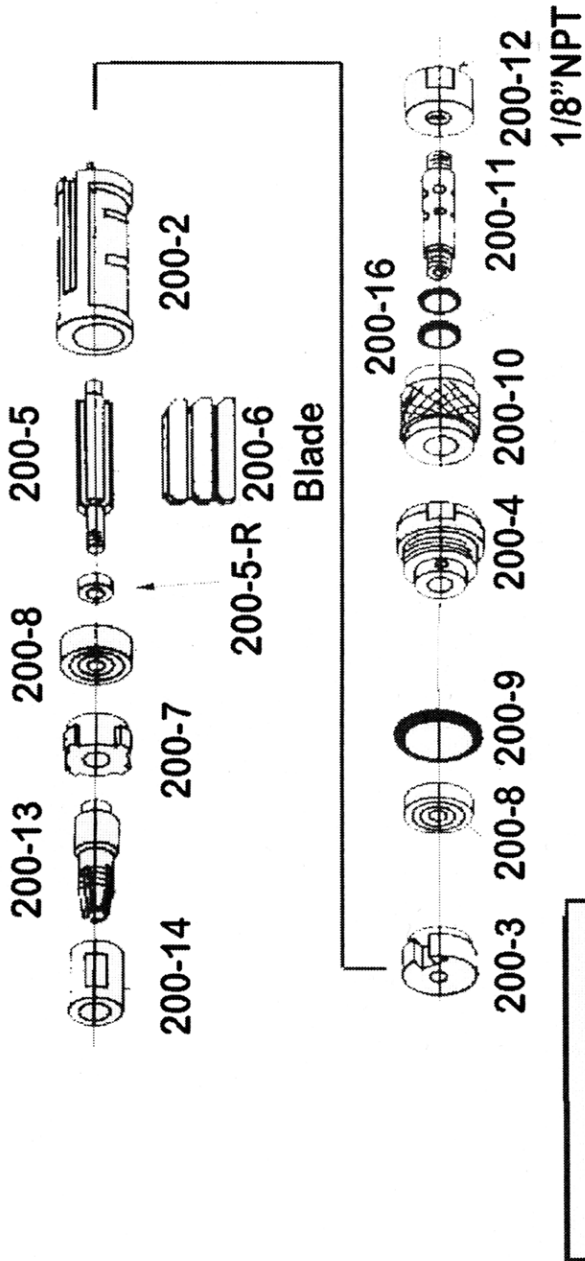
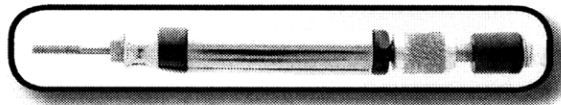
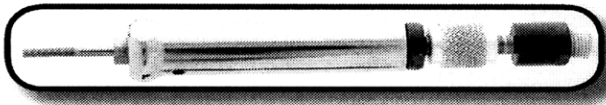
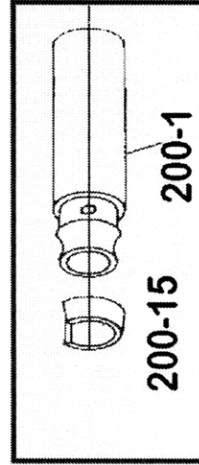
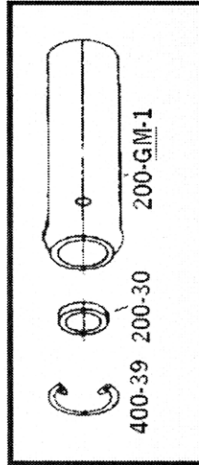

Motor Cases

Models
20 G
20 GM

Just Tools Inc.

33 Haas Road, Toronto, On M9W 3A1

Tel: 416-748-0707 Fax: 416-748-0706 1-888-748-0707 E-mail: sales@justools.com

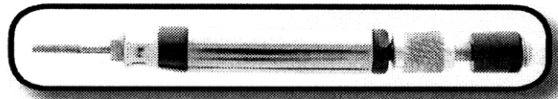
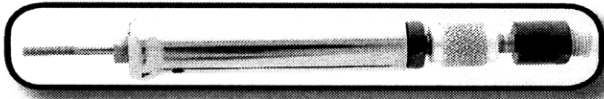

This tool is designed to operate on 90 psig(6.2bar) maximum air pressure with 1/8" (3.25mm) hose. Wear safety goggles. Do not use any wheel wheel or carbide burr for which the operating speed that is rated lower than 60,000 R.P.M.

Models

20 G

20 GM

Part Number	Description
200-1	Case
200-GM-1	Case
200-2	Cylinder
200-3	Rear Thrust plate
200-4	Coupling
200-5	Rotor
200-5-R	Spacer
200-6	Blades (3 are req'd in this tool.)
200-7	Front thrust plate
200-8	Bearing (2 are required per tool)
200-9	O-ring
200-10	valve sleeve
200-11	Valve stem
200-12	Valve coupling
* 200-13	Collet (see notation)
200-13-3	3mm collet
200-13-098	"3/32"" collet"
200-14 *	Collet nut
200-15	Exhaust sleeve
200-16	O-Ring (2 are req'd)
200-17	Collet lock pin
200-30	Muffler
400-39	Lock ring
11000-028-1	"9/32"" wrench"
*Purchase as AA-100-13&14 collet and nut assembly.	
200-41	"1/8"x 5' hose
530198	Taper carbide burr
530200	Tree type burr
530202	Ball type burr
530204 Cylindrical plain type carbide burr.	Cylindrical plain type carbide burr.

