

573 Engraving Pen

Operating Instructions
Servicing Instructions
Parts List

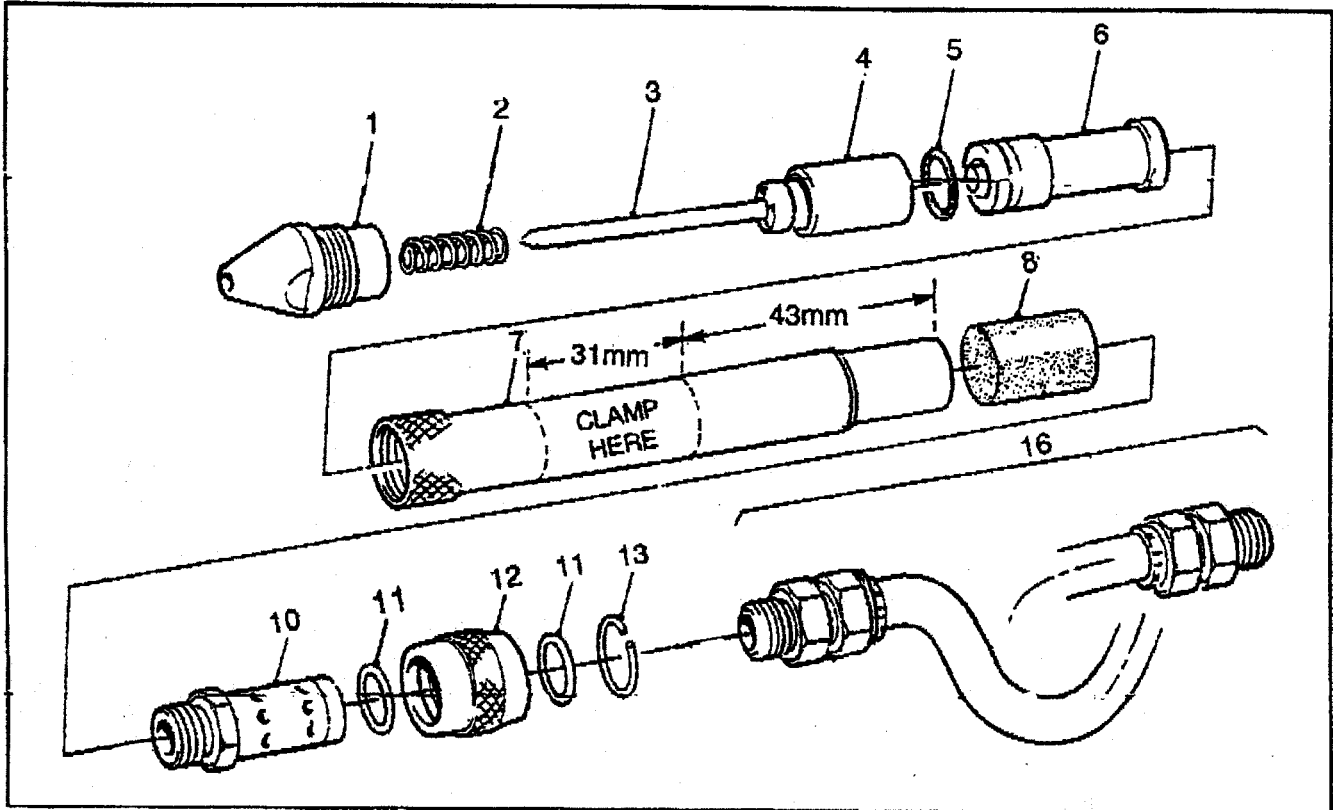

MAXIMUM WORKING PRESSURE: -4.1 bar. (60 lbf. in²).

OPERATION

Check that the outer sleeve of the On/Off Valve is at the top of its travel: the "OFF" position.

Connect the tool to an air supply, the pressure of which should be set between 2.75 and 4.1 bar. (40 and 60lbf.in²).

Switch on the tool and carry out a trial operation. The air supply pressure should be adjusted to suit the material being worked; bearing in mind that tool life will be extended if an acceptable result can be obtained on a lower air pressure.

For consistent performance the tip of the stylus must have a sharp point.

MAINTENANCE

Position clamp blocks, in the position shown, on the body, and clamp in vice.

Unscrew nose and withdraw spring, stylus and distance tube.

Unscrew the on/off valve and withdraw the air filter. Using a length of rod push lightly through the air inlet to remove the cylinder and piston assembly.

The tip of the stylus can be reground using a Green Silicone Carbide stone and grinding to an angle of 60°inc.

Clean the components, replace parts as necessary, then assemble the tool, noting that the nose should be tightened to a torque of 4.3Nm (38lbf.in.)

Item No.	Description	Qty.
1	Nose	1
2	Spring	1
*3	Stylus	1
4	Distance Tube	1
*5	"O" Ring	1
6	Cylinder & Piston Assembly	1
7	Body	1
8	Air Filter	1
10	Valve Stem	1
*11	"O" Ring	2
12	Valve Sleeve	1
*13	Circlip	1
		1
		1
*16	Hose Complete—2 metre	1

Just Tools Inc.

33A Haas Road, Toronto, On M9W 3A1

Tel: 416-748-0707 Fax: 416-748-0706

Toll Free: 1-888-748-0707 E-mail: sales@justools.com