

1" IMPACT WRENCH MODEL MI-3800P

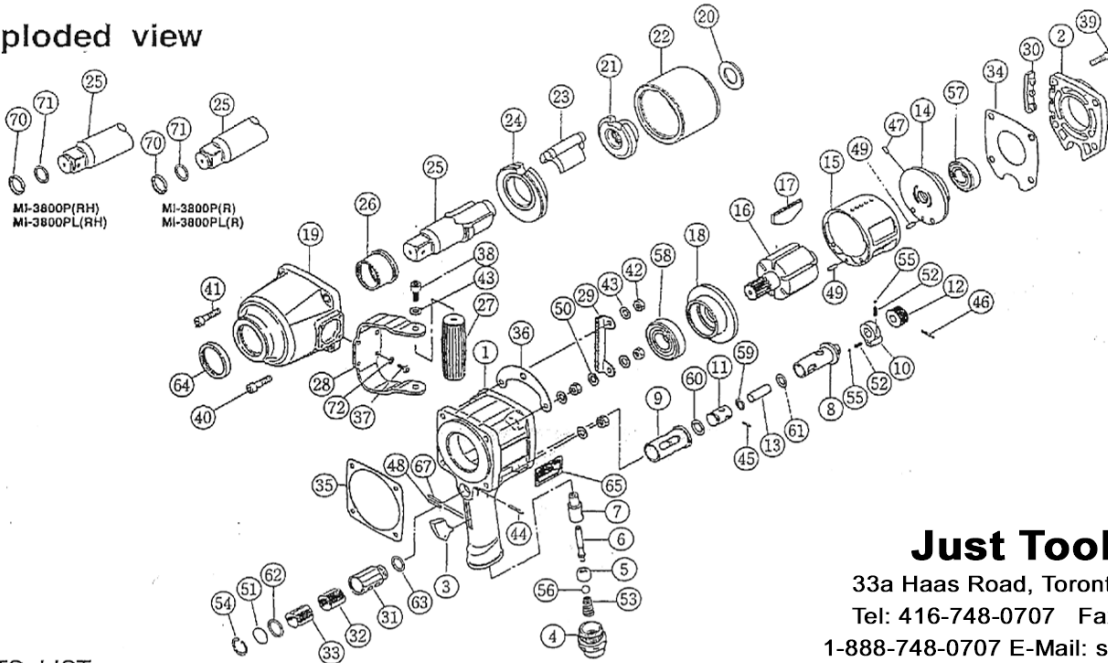

TOKU PNEUMATIC PRODUCTS

Exploded view



Just Tools Inc.

33a Haas Road, Toronto, On M9W 3A1

Tel: 416-748-0707 Fax: 416-748-0706

1-888-748-0707 E-Mail: sales@justools.com

PARTS LIST MI-3800P

Index No.	Parts No.	Description	No. Req.
001	43-16-35-010	Motor Housing	1
002	43-16-35-350	Housing Cover	1
003	43-12-67-130	Trigger	1
004	46-11-60-90B	Air Inlet (PT)	1
005	13-55-05-009	Throttle Valve	1
006	46-11-61-045	Throttle Push Rod	1
007	46-11-61-035	Throttle Valve Bushing	1
008	46-11-62-105	Reverse Valve	1
009	46-11-62-115	Reverse Valve Bushing	1
010	46-11-62-125	Reverse Valve Lever	1
011	46-11-62-405	Control Valve	1
012	46-11-62-425	Control Valve Knob	1
013	46-11-62-445	Control Valve Rod	1
014	43-12-66-370	Rear End Plate	1
015	43-12-66-360	Liner	1
016	43-12-88-390	Rotor	1
017	13-71-10-003	Vane	6
018	43-12-66-380	Front End Plate	1
019	43-12-66-520	Clutch Housing	1
020	43-12-66-480	Thrust Plate	1
021	43-12-66-430	Cam	1
022	43-12-66-440	Cage	1
023	43-16-61-450	Dog	1
024	43-12-66-470	Cage Bushing	1
025	43-12-66-500	Anvil Shank (H)	1
026	43-12-66-530	Housing Bushing	1
027	43-12-66-620	Grip	1
028	43-16-81-550	Dead Handle	1
029	13-62-01-015	Protector (F)	1
030	13-66-06-001	Protector (R)	1
031	46-11-67-805	Exhaust Deflector	1
032	46-19-40-428	Silencer	1
033	46-11-68-355	Filter	1
034	46-11-68-535	Motor Housing Packing	1
035	13-61-04-002	Clutch Housing Packing	1
036	46-11-67-945	Frying Plate	1
037	13-19-05-014	Hex. Socket Button Head Screw M5X14	4
038	13-19-08-016	Hex. Socket Button Head Cap Screw M8X16	2
039	13-17-08-030	Hex. Socket Head Cap Screw M8X30	4
040	13-17-08-035	Hex. Socket Head Cap Screw M8X35	1
041	13-17-08-040	Hex. Socket Head Cap Screw M8X40	3
042	13-44-01-008	Hex. Nut M8	4
043	13-13-09-008	Washer M8	6
044	46-97-11-660	Pin 2.5X26	1
045	46-97-11-140	Pin 2X14	1
046	13-06-02-024	Spring Pin 2X24	1
047	13-06-03-010	Spring Pin 3X10	1
048	13-06-03-024	Spring Pin 3X24	1
049	13-06-04-014	Spring Pin 4X14	2

Index No.	Parts No.	Description	No. Req.
050	46-97-50-650	Spacer	1
051	46-97-56-030	Exhaust Plate	1
052	46-97-60-270	Spring 3X11	2
053	13-08-08-002	Throttle Valve Spring 10X15X25	1
054	13-03-01-024	Retaining Ring H-24	1
055	13-05-02-008	Steel Ball 1/8	2
056	13-05-05-028	Polyurethan Rubber Ball 7/16	1
057	13-01-07-005	Bearing 6204	1
058	13-01-07-006	Bearing 6205	1
059	13-11-01-008	O-Ring P-10	1
060	13-11-01-012	O-Ring P-12	1
061	13-11-01-016	O-Ring P-16	1
062	13-11-01-018	O-Ring P-20	1
063	13-11-03-016	O-Ring S-20	1
064	13-12-02-048	Oil Seal VB-40525	1
065	13-73-05-034	Name Plate	1
067	13-06-03-020	Spring Pin 3X20	1
072	13-13-10-005	Spring Washer M5	4
	43-16-35-01B	Motor Housing CP (Incl. Index No.1,7&9)	(1CP)
	43-12-66-52B	Clutch Housing CP (Incl. Index No.19,26&64)	(1CP)
	43-16-81-55C	Dead Handle CP (Incl. Index No.27,28,38&43)	(1CP)
MI-3800P(R)			
Index No.	Parts No.	Description	No. Req.
025	43-12-75-500	Anvil Shank (R)	1
070	13-08-03-144	Socket Retainer Ring	1
071	13-11-05-013	O-Ring 6227-13	1
	43-12-75-50C	Anvil Shank (R) CP (Incl. Index No.25,70&71)	(1CP)
MI-3800PL(R)			
Index No.	Parts No.	Description	No. Req.
025	43-12-73-500	Anvil Shank L (R)	1
070	13-08-03-144	Socket Retainer Ring	1
071	13-11-05-013	O-Ring 6227-13	1
	43-12-73-50C	Anvil Shank L (R) CP (Incl. Index No.25,70&71)	(1CP)
MI-3800P(RH)			
Index No.	Parts No.	Description	No. Req.
025	43-16-44-900	Anvil Shank (RH)	1
070	13-08-03-144	Socket Retainer Ring	1
071	13-11-05-013	O-Ring 6227-13	1
	43-16-44-90C	Anvil Shank (RH) CP (Incl. Index No.25,70&71)	(1CP)
MI-3800PL(RH)			
Index No.	Parts No.	Description	No. Req.
025	43-16-43-900	Anvil Shank L (RH)	1
070	13-08-03-144	Socket Retainer Ring	1
071	13-11-05-013	O-Ring 6227-13	1
	43-16-43-90C	Anvil Shank L (RH) CP (Incl. Index No.25,70&71)	(1CP)