

# Just Tools Inc.

33a Haas Road, Toronto, On M9W 3A1  
 Tel: 416-748-0707 Fax: 416-748-0706 1-888-748-0707  
 E-mail:sales@justtools.com

## STP-2506

1/4" Auto Shut-off (Pistol Grip)  
 Screwdriver

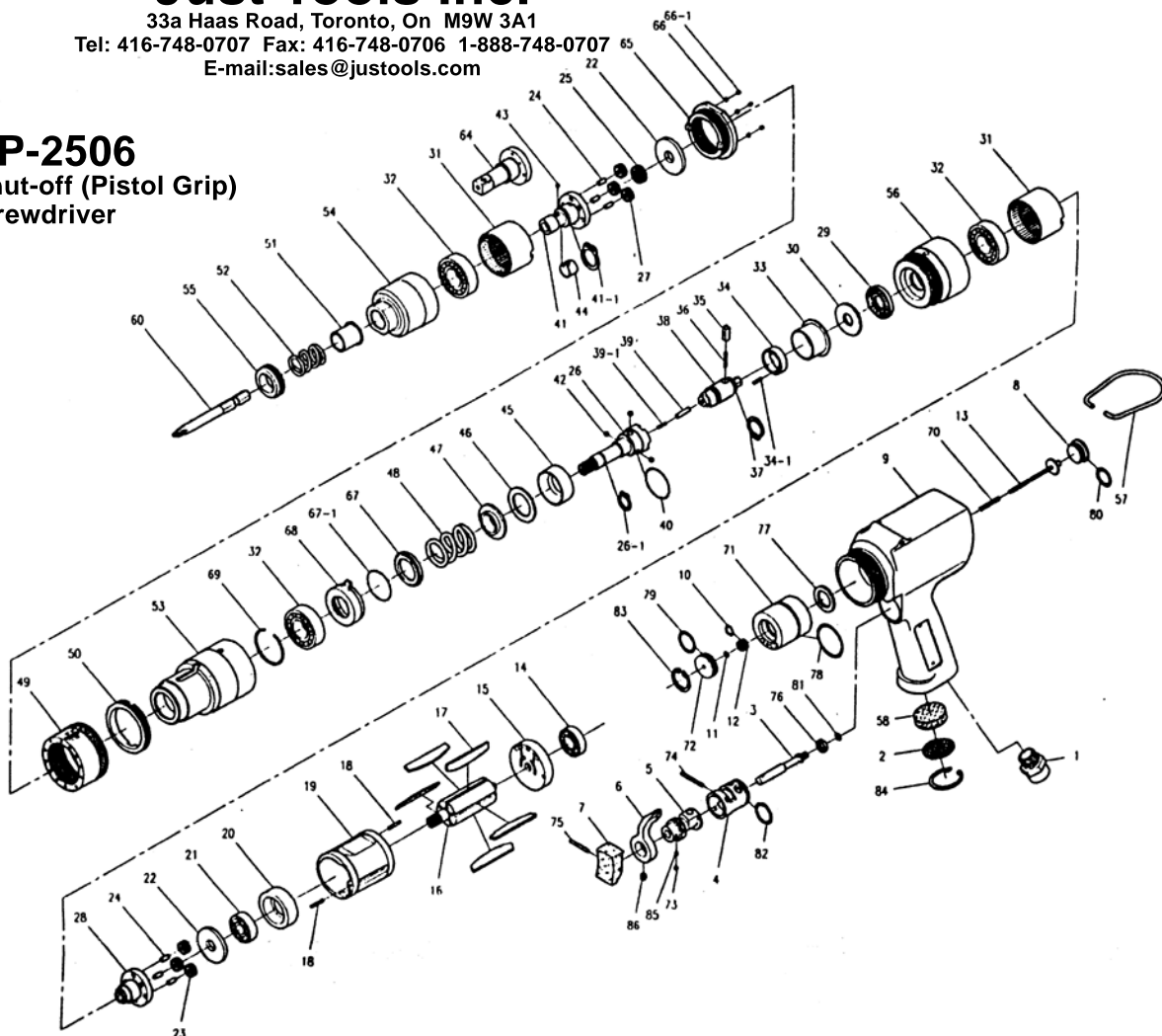

PART LIST (WHEN ORDERING SPARE PART, PLEASE SPECIFY TOOL MODEL, PART NO. AND PART NAME)

REF NO	PART NO	PART NAME	QTY	REF NO	PART NO	PART NAME	QTY	REF NO	PART NO	PART NAME	QTY
1	9090-1/4	AIRINLET 1/4	1	29	0250-211	SPACER(PLATE BEARING)	1	55	0180-610	BIT BUSHING CASING	1
2	0101-090	EXHAUST DEFLECTOR	1	30	9029-12	BALL BEARING(1226)	1	56	0250-210	GAER CASING	1
3	0101-030	TRIGGER BAR	1	31	0250-220	INTERNAL GAER	1	57	0220-080	SUSPENSION RING	1
4	0101-021	VALVE	1	32	9026-002	BALL BEARING(6002)	1	58	0101-091	MUFFLER FILTER	1
5	0101-020	REVERSE VALVE	1	33	0180-363	BALL KEEPER	1	60	9102-50	BIT NO2(6.35*50)	1
6	0101-022	REVERSE LEVER	1	34	0140-362	CONTROL RING	1	64	0250-650	ANVIL(SQ. 3/8")	1
7	0101-032	TRIGGER	1	341	9031-011	NEEDLE PIN 1.5*7.8	3	65	0250-611	CASING CONNECTOR	1
8	0101-011	SCREW CAP	1	35	0140-361	CONTROL PIN	1	66	9110-003	SCREWC(M4*0.7)	1
9	0250-010	PISTOL CASING	1	36	9070-001	SPRING(2.35*7)	1	661	9010-2.4	BALL(2.4M/M)	1
10	9061-060	O.RING(6.1*1)	1	37	9050-S12	S TYPE HOLDER(S12)	1	67	0250-692	BALL KEEPER (INNER)	1
11	9061-020	O.RING(2*1.5)	1	38	0180-360	DRIVING CLUTCH	1	671	9010-1.6	BALL(1.58)	50
12	0100-051	ORING HOLDER	1	39	9033-13	NEEDLE PIN 3*12.8	1	68	0250-693	BALL KEEPER	1
13	0250-040	START BAR	1	391	9070-002	SPRING(2.5*8)	1	69	9051-30	RING	1
14	9020-626	BALL BEARING(626)	1	40	9010-2.4	BALL(2.4/M/M)	19	70	9070-303	SPRING(3*14)	1
15	0250-111	FRONT PLATE	1	41	0250-630	ANVIL(HEX6.35)	1	71	0221-050	REAR PLATE VALVE	1
16	0250-130	ROTOR	1	411	9050-S15	S TYPE HOLDER(S15)	1	72	0181-052	ORING HOLDER CAP	1
17	0601-140	BLADE	6	42	9010-4	BALL(5/32)	3	73	9010-3.2	BALL(1/8)	2
18	9032-16	NEEDLE PIN 2*16	1	43	9010-3.2	BALL(1/8)	1	74	9032-23	NEEDLE PIN 2*22.8	1
19	0601-120	CYLINDER	1	44	0140-640	BALL BAND	1	75	9032-16	NEEDLE PIN 2*15.8	1
20	0250-111	REAR PLATE	1	45	0250-350	CLUTCH	1	76	0101-023	SLUT SPACER(TFL)	1
21	9020-EE3	BALL BEARING(EE3)	1	46	0250-351	SPACER	1	77	0101-053	SPACER(PU)	1
22	0180-116	SPACER(3M/M)	1	47	0250-352	SPACER(TFL)	1	78	9061-026	O.RING(31*1.78)	1
23	0220-240	PLANET GEAR	3	48	9070-506	SPRING(24*24*2.6)	1	79	9060-015	O.RING(14.1*1.78)	1
24	9033-011	NEEDLE PIN 3.5*9.8	6	49	0250-690	ADJUSTING NUT	1	80	9062-111	O.RING(11*2)	1
25	0220-230	SUN GEAR	1	50	0250-691	ADJUSTING NUTLOCK	1	81	9061-030	O.RING(3.5*1.5)	1
26	0250-330	CLUTCH SHANK	1	51	0140-620	ANVIL BUSHING	1	82	9060-016	O.RING(15.6*1.78)	1
261	9050-S10	S TYPE HOLDER(S10)	1	52	9070-401	SPRING(17.1*10)	1	83	9050-R18	R TYPE HOLDER(R18)	1
27	0220-241	PLANET GEAR	1	53	0250-310	CLUTCH CASING	1	84	9050-R24	R TYPE HOLDER(R24)	1
28	0250-230	GEAR CAGE	1	54	0250-610	BIT CASING	1	85	9070-001	SPRING(2.35*7)	1
								86	9110-003	SCREW(M4*0.7)	1